

**NORTHAMPTON BOROUGH COUNCIL**

**LICENSING ACT 2003**

**LICENSING SUB COMMITTEE**

A Meeting of the Licensing Sub-Committee will be held at The Council Chamber, St. Giles Square, Northampton, NN1 1DE. on Monday, 27 November 2017 at 10:00 am

**S Bovey**

**Interim Chief Executive**

**AGENDA**

- 1. WELCOMES**
- 2. DECLARATIONS OF INTEREST**
- 3. PREMISES LICENCE APPLICATION - ARYAN COFFEE**
- 4. EXCLUSION OF PUBLIC AND PRESS**

The Chair to move:

“That the public and press be excluded from the remainder of the meeting on the grounds that there is likely to be disclosure to them of such categories of exempt information as defined by Section 100(1) of the Local Government Act 1972 as listed against such items of business by reference to the appropriate paragraph of Schedule 12A to such act.”

**SUPPLEMENTARY AGENDA**

Exempted Under Schedule 12A of the Local Government Act 1972

Para No:-

## PROCEDURES FOR LICENSING SUB-COMMITTEE HEARING

- **Welcome** – Chairman welcomes the Applicant, Representors, Responsible Authorities and Interested Parties and introduces members of the sub-committee (+ other officers e.g. Solicitor, Licensing Officer, Democratic Services Officer etc).
- **Declarations of Interest by Councillors**
- **Reason for Hearing** – to be outlined by the **Licensing Officer** or the **Chair**.
- **Format of the hearing** – an explanation of the format of the proceedings:
  1. **Applicant** (or his/her representative) will address the sub-committee first and put their case.
  2. **The Chair** leads an examination of the **Applicant's case**. First, the panel may ask questions and then the Chair invites Responsible and Interested Parties to participate. Questions may only relate to the points made by the applicant.
  3. **The Representors/Respondents** (and responsible and Interested Parties) then state their case.
  4. **The Chair** leads an examination of the **Representor's case**.

Each party will be given an equal maximum period of time in which to present their case and may, if given permission by the Chair, question any other party.

- **Summing Up**
  - By the Representors/Respondents
  - By the Applicant
- **Sub-committee retires** – and may call for the Solicitor for advice if required.
- **Sub-Committee deliver their decision and reasons for their decision at the conclusion of the meeting IF:**
  1. Application for conversion of existing licence
  2. Application for conversion of existing club certificate
  3. Application by holder of justices' licence for grant of personal licence
  4. Application for conversion and variation of premises licence (including variation of DPS)
  5. Application for conversion and variation of club premises certificate
  6. Counter notice following police objection to temporary event notice
  7. Review of Premises Licence following Closure Order

In all other cases, the Sub-committee delivers its decision and reasons for its decision within five working days beginning with the day on which the hearing was held.

**If you require any further information regarding this meeting please contact Democratic Services on 01604 837722 or [democraticservices@northampton.gov](mailto:democraticservices@northampton.gov)**



## **NEW GRANT PREMISES LICENCE APPLICATION –**

### **Licensing Sub-Committee**

**Monday 27th November 2017**

#### **1.0 Purpose of Report**

- 1.1 To consider an application for the new grant of a premises licence. Mr Sarbaz Amin Abdullah in relation to the new grant of a premises licence for 166-168 Lutterworth Road, Northampton, NN1 5JL.

#### **2.0 Summary**

- 2.1 An application for the new grant of a premises licence was submitted by Licensed Intuition on behalf of the proposed licence holder and designated premises supervisor Mr Sarbaz Amin Abdullah. The application was received by Northampton Borough Council on the 10<sup>th</sup> October 2017. Mr Abdullah is the licence holder and designated premises supervisor at two other premises within Northampton.

As part of the applications operation schedule, the applicant has also submitted a number of steps that the licence holder has agreed to implement in order to promote the licensing objectives.

#### **3.0 Application Details**

- 3.1 The application was submitted with the intention to licence the premises in order to trade as a Restaurant/ Café style business licensed to sell Alcohol ancillary to a meal and provide late night refreshment.
- 3.2 The licensable activities and times requested on the application are for the following;

**Sales of Alcohol for consumption On the premises:**

Monday – Sunday 08:00 – 00:00 Midnight

**Late Night refreshment:**

Monday – Sunday 08:00- 00:00 Midnight

**Opening Hours:**

Friday – Sunday 08:00am – 00:00 Midnight

- 3.3 The proposed Designated Premises Supervisor is:

**Mr Sarbaz Amin Abdullah**

**Personal Licence Number: WNPA009915**

**Issuing Authority: Kings Lynn & Norfolk**

#### **4.0 Consultations/Representations**

- 4.1 When a request for the new grant of a premises licence or club premises certificate is received, the applicant must display a notice at or near the premises and serve a copy of the application onto the responsible authorities. For electronic applications it is a requirement of the local authority to serve a copy of the application onto the responsible authorities.

This gives responsible authorities and interested parties the opportunity to make representations in relation to the application for a period of 28 calendar days. The last date for representation was the 7<sup>th</sup> November 2017.

- 4.2 The obligatory notice was displayed on the premises as verified by licensing officers on the 3<sup>rd</sup> October 2017 and in a local newspaper on the 19<sup>th</sup> October 2017.
- 4.3 The Licensing Department has received one relevant representation under the licensing objective of public nuisance from a resident of Lutterworth Road.
- 4.4 Northamptonshire police have considered the application and have come to an agreement of the licence conditions.
- 4.5 Environmental Protection have considered the above mentioned premises licence application pertinent to the licencing objective of the prevention of public nuisance. The condition recommended is that only background music can be played during permitted opening hours.

#### **5.0 Attendance**

- 5.1 The local authority is required to send a notice of hearing to all interested parties and request confirmation of attendance. A notice of hearing was sent to the following persons on the 7<sup>th</sup> November 2017.

**Member of Public – confirmation of attendance pending**

**Paul Byatt of Licensed Intuition – confirmation of attendance pending**

## **6.0 Plan of Premises Layout & Location**

Please see premises Plan and Location map attached

## **7.0 Options**

7.1 At the end of the consultation period the licensing authority must hold a hearing. It must take such steps as it considers appropriate for the promotion of the licensing objectives, which are:

- the prevention of crime and disorder
- public safety
- the prevention of public nuisance
- the protection of children from harm

The steps the Sub-Committee can take are to:

- reject the application;
- grant the licence subject to modifying the conditions of the licence (excluding the mandatory conditions);
- refuse to specify an individual as a designated premises supervisor;
- exclude from the scope of the of the licence any of the licensable activities to which the application relates.

## **8.0 Policy Considerations**

8.1 Statement of Licensing Policy

8.2 s.182 Guidance Licensing Act 2003

Section 9 gives guidance for determination of this application.

Sections 8 & 10 highlights the elements of the Guidance that are most relevant with respect to this application. This is not exhaustive and guidance should be considered fully prior to making decisions with respect to applications.

## **9.0 Committee**

Each application must be considered on its own merits and any conditions attached to licences and certificates must be tailored to the individual style and characteristics of the premises and events concerned. This is essential to avoid the imposition of disproportionate and overly burdensome conditions on

premises where there is no need for such conditions. Standardised conditions should be avoided and indeed, may be unlawful where they cannot be shown to be necessary for the promotion of the licensing objectives in any individual case.

<b>Appendix No</b>	<b>Title</b>
<b>1.</b>	Application & Conditions of Operating Schedule
<b>2.</b>	Premises Plan and Location map
<b>3.</b>	Public Notice
<b>4.</b>	Agreed Police and Environmental Health conditions
<b>5.</b>	Further representations from member of the public
<b>Report Author</b>	Eleanor Flannery Licensing Enforcement Officer

67460

PASSED FOR NOTICE CHECK 13.10

OK 8131 7385 408 SIGNED FOR

Application for a premises licence to be granted  
under the Licensing Act 2003

PLEASE READ THE FOLLOWING INSTRUCTIONS FIRST

Before completing this form please read the guidance notes at the end of the form. If you are completing this form by hand please write legibly in block capitals. In all cases ensure that your answers are inside the boxes and written in black ink. Use additional sheets if necessary.

You may wish to keep a copy of the completed form for your records.

*Amin*  
I/we *SARBAZ, ABDULLAH.*  
(Insert name(s) of applicant)

apply for a premises licence under section 17 of the Licensing Act 2003 for the premises described in Part 1 below (the premises) and I/we are making this application to you as the relevant licensing authority in accordance with section 12 of the Licensing Act 2003

Part 1 – Premises details

Postal address of premises or, if none, Ordnance Survey map reference or description			
<i>'ARYAN COFFEE</i> <i>166-168 LUTTERWORTH ROAD</i>			
Post town	<i>NORTHAMPTON</i>	Postcode	<i>NN1 5JL</i>

Telephone number at premises (if any)	
Non-domestic rateable value of premises	£ <i>12,250</i> <i>Rand B.</i>

Part 2 - Applicant details

Please state whether you are applying for a premises licence as      Please tick as appropriate

- a) an individual or individuals \*       please complete section (A)
- b) a person other than an individual \*
- i as a limited company/limited liability partnership       please complete section (B)
- ii as a partnership (other than limited liability)       please complete section (B)
- iii as an unincorporated association or       please complete section (B)
- iv other (for example a statutory corporation)       please complete section (B)
- c) a recognised club       please complete section (B)
- d) a charity       please complete section (B)

Notes for Page 3  
PASSED FOR NOTICE CHECK 13.10  
13/10/2017 09:48:42  
LFAULKNER

67460  
10/10/2017 14:46:15  
EPHILLIPS



**A**

Plays Standard days and timings (please read guidance note 7)			Will the performance of a play take place indoors or outdoors or both – please tick (please read guidance note 3)	Indoors	<input type="checkbox"/>
Day	Start	Finish		Outdoors	<input type="checkbox"/>
Mon			Please give further details here (please read guidance note 4)		
Tue					
Wed			State any seasonal variations for performing plays (please read guidance note 5)		
Thur					
Fri			Non standard timings. Where you intend to use the premises for the performance of plays at different times to those listed in the column on the left, please list (please read guidance note 6)		
Sat					
Sun					

**B**

<b>Films</b> Standard days and timings (please read guidance note 7)			<b>Will the exhibition of films take place indoors or outdoors or both – please tick</b> (please read guidance note 3)	Indoors	<input type="checkbox"/>
				Outdoors	<input type="checkbox"/>
				Both	<input type="checkbox"/>
<b>Day</b>	<b>Start</b>	<b>Finish</b>	<b>Please give further details here</b> (please read guidance note 4)		
Mon					
Tue			<b>State any seasonal variations for the exhibition of films</b> (please read guidance note 5)		
Wed					
Thur			<b>Non standard timings. Where you intend to use the premises for the exhibition of films at different times to those listed in the column on the left, please list</b> (please read guidance note 6)		
Fri					
Sat					
Sun					

C

Indoor sporting events Standard days and timings (please read guidance note 7)			Please give further details (please read guidance note 4)
Day	Start	Finish	
Mon			
Tue			State any seasonal variations for indoor sporting events (please read guidance note 5)
Wed			
Thur			Non standard timings. Where you intend to use the premises for indoor sporting events at different times to those listed in the column on the left, please list (please read guidance note 6)
Fri			
Sat			
Sun			

**D**

<b>Boxing or wrestling entertainments</b> Standard days and timings (please read guidance note 7)			<b>Will the boxing or wrestling entertainment take place indoors or outdoors or both – please tick</b> (please read guidance note 3)	Indoors	<input type="checkbox"/>
				Outdoors	<input type="checkbox"/>
Day	Start	Finish		Both	<input type="checkbox"/>
Mon			<u>Please give further details here</u> (please read guidance note 4)		
Tue					
Wed			<u>State any seasonal variations for boxing or wrestling entertainment</u> (please read guidance note 5)		
Thur					
Fri			<u>Non standard timings. Where you intend to use the premises for boxing or wrestling entertainment at different times to those listed in the column on the left, please list</u> (please read guidance note 6)		
Sat					
Sun					

**E**

<b>Live music</b> Standard days and timings (please read guidance note 7)			<b>Will the performance of live music take place indoors or outdoors or both – please tick</b> (please read guidance note 3)	Indoors	<input type="checkbox"/>
				Outdoors	<input type="checkbox"/>
				Both	<input type="checkbox"/>
Day	Start	Finish	<b>Please give further details here</b> (please read guidance note 4)		
Mon					
Tue					
Wed			<b>State any seasonal variations for the performance of live music</b> (please read guidance note 5)		
Thur					
Fri			<b>Non standard timings. Where you intend to use the premises for the performance of live music at different times to those listed in the column on the left, please list</b> (please read guidance note 6)		
Sat					
Sun					

**F**

Recorded music Standard days and timings (please read guidance note 7)			Will the playing of recorded music take place indoors or outdoors or both – please tick (please read guidance note 3)	Indoors	<input type="checkbox"/>
Day	Start	Finish		Outdoors	<input type="checkbox"/>
Mon			Please give further details here (please read guidance note 4)	Both	<input type="checkbox"/>
Tue					
Wed			State any seasonal variations for the playing of recorded music (please read guidance note 5)		
Thur					
Fri			Non standard timings. Where you intend to use the premises for the playing of recorded music at different times to those listed in the column on the left, please list (please read guidance note 6)		
Sat					
Sun					

**G**

Performances of dance Standard days and timings (please read guidance note 7)			Will the performance of dance take place <u>indoors or outdoors or both – please tick</u> (please read guidance note 3)	Indoors	<input type="checkbox"/>
Day	Start	Finish		Outdoors	<input type="checkbox"/>
Mon			<b>Please give further details here</b> (please read guidance note 4)	Both	<input type="checkbox"/>
Tue					
Wed			<b>State any seasonal variations for the performance of dance</b> (please read guidance note 5)		
Thur					
Fri			<b>Non standard timings. Where you intend to use the premises for the performance of dance at different times to those listed in the column on the left, please list</b> (please read guidance note 6)		
Sat					
Sun					

**H**

<b>Anything of a similar description to that falling within (e), (f) or (g)</b> Standard days and timings (please read guidance note 7)			Please give a description of the type of entertainment you will be providing		
Day	Start	Finish	<b>Will this entertainment take place indoors or outdoors or both – please tick</b> (please read guidance note 3)	Indoors	<input type="checkbox"/>
Mon				Outdoors	<input type="checkbox"/>
				Both	<input type="checkbox"/>
Tue			<b>Please give further details here</b> (please read guidance note 4)		
Wed					
Thur			<b>State any seasonal variations for entertainment of a similar description to that falling within (e), (f) or (g)</b> (please read guidance note 5)		
Fri					
Sat			<b>Non standard timings. Where you intend to use the premises for the entertainment of a similar description to that falling within (e), (f) or (g) at different times to those listed in the column on the left, please list</b> (please read guidance note 6)		
Sun					



I

Late night refreshment Standard days and timings (please read guidance note 7)			Will the provision of late night refreshment take place indoors or outdoors or both – please tick (please read guidance note 3)	
Day	Start	Finish		
Mon	23 <sup>00</sup> <del>23<sup>00</sup></del>	00-00 <del>midnight</del>		Indoors <input checked="" type="checkbox"/> Outdoors <input type="checkbox"/> Both <input type="checkbox"/>
Tue	23 <sup>00</sup> <del>23<sup>00</sup></del>	00-00		Please give further details here (please read guidance note 4)
Wed	23 <sup>00</sup> <del>23<sup>00</sup></del>	00-00		
Thur	23 <sup>00</sup> <del>23<sup>00</sup></del>	00-00	State any seasonal variations for the provision of late night refreshment (please read guidance note 5)	
Fri	23 <sup>00</sup> <del>23<sup>00</sup></del>	00-00		
Sat	23 <sup>00</sup> <del>23<sup>00</sup></del>	00-00	Non standard timings. Where you intend to use the premises for the provision of late night refreshment at different times, to those listed in the column on the left, please list (please read guidance note 6)	
Sun	23 <sup>00</sup> <del>23<sup>00</sup></del>	00-00		

**J**

Supply of alcohol Standard days and timings (please read guidance note 7)			Will the supply of alcohol be for consumption = please tick (please read guidance note 8)	On the premises	<input checked="" type="checkbox"/>
Day	Start	Finish		Off the premises	<input type="checkbox"/>
Mon	08:00	00:00	State any seasonal variations for the supply of alcohol (please read guidance note 5)	Both	<input type="checkbox"/>
Tue	08:00	00:00			
Wed	08:00	00:00			
Thur	08:00	00:00	Non standard timings. Where you intend to use the premises for the supply of alcohol at different times to those listed in the column on the left, please list (please read guidance note 6)		
Fri	08:00	00:00			
Sat	08:00	00:00			
Sun	08:00	00:00			

State the name and details of the individual whom you wish to specify on the licence as designated premises supervisor (Please see declaration about the entitlement to work in the checklist at the end of the form):

Name	SARBAZ AMIN ABDULLAH.
Date of birth	
Address	
Postcode	
Personal licence number (if known)	
Issuing licensing authority (if known)	BOROUGH COUNCIL OF KINGS LYNN AND WEST NORFOLK

**Supply of alcohol** (if ticking yes, fill in box J)

**In all cases complete boxes K, L and M**

If you wish the licence to be valid only for a limited period, when do you want it to end?

DD MM YYYY  
~~07/11/2017~~

Please give a general description of the premises (please read guidance note 1)

RESTAURANT  
~~REST~~ CAFE LICENSED TO SELL ALCOHOL  
ANCILLARY TO A MEAL.

If 5,000 or more people are expected to attend the premises at any one time, please state the number expected to attend.

What licensable activities do you intend to carry on from the premises?

(please see sections 1 and 14 and Schedules 1 and 2 to the Licensing Act 2003)

Provision of regulated entertainment (please read guidance note 2)

Please tick all that apply

- a) plays (if ticking yes, fill in box A)
- b) films (if ticking yes, fill in box B)
- c) indoor sporting events (if ticking yes, fill in box C)
- d) boxing or wrestling entertainment (if ticking yes, fill in box D)
- e) live music (if ticking yes, fill in box E)
- f) recorded music (if ticking yes, fill in box F)
- g) performances of dance (if ticking yes, fill in box G)
- h) anything of a similar description to that falling within (e), (f) or (g) (if ticking yes, fill in box H)

**Provision of late night refreshment** (if ticking yes, fill in box I)

Date of birth		I am 18 years old or over <input type="checkbox"/> Please tick yes	
Nationality			
Current residential address if different from premises address			
Post town		Postcode	
Daytime contact telephone number			
E-mail address (optional)			

**(B) OTHER APPLICANTS**

Please provide name and registered address of applicant in full. Where appropriate please give any registered number. In the case of a partnership or other joint venture (other than a body corporate), please give the name and address of each party concerned.

Name
Address
Registered number (where applicable)
Description of applicant (for example, partnership, company, unincorporated association etc.)
Telephone number (if any)
E-mail address (optional)

**Part 3 Operating Schedule**

When do you want the premises licence to start?

DD MM YYYY  
 07 11 2012

- e) the proprietor of an educational establishment  please complete section (B)
- f) a health service body  please complete section (B)
- g) a person who is registered under Part 2 of the Care Standards Act 2000 (c14) in respect of an independent hospital in Wales  please complete section (B)
- ga) a person who is registered under Chapter 2 of Part 1 of the Health and Social Care Act 2008 (within the meaning of that Part) in an independent hospital in England  please complete section (B)
- h) the chief officer of police of a police force in England and Wales  please complete section (B)

\* If you are applying as a person described in (a) or (b) please confirm (by ticking yes to one box below):

- I am carrying on or proposing to carry on a business which involves the use of the premises for licensable activities; or
- I am making the application pursuant to a  
 statutory function or   
 a function discharged by virtue of Her Majesty's prerogative

**(A) INDIVIDUAL APPLICANTS (fill in as applicable)**

Mr <input checked="" type="checkbox"/>	Mrs <input type="checkbox"/>	Miss <input type="checkbox"/>	Ms <input type="checkbox"/>	Other Title (for example, Rev)
Surname <b>ABDULLAH</b>		First names <b>SARBAZ, AWIN.</b>		
Date of birth		old or over <input checked="" type="checkbox"/> Please tick yes		
Nationality				
Current residential address if different from premises address				
Post town				Postcode
Daytime contact telephone number				
E-mail address (optional)				

**SECOND INDIVIDUAL APPLICANT (if applicable)**

Mr <input type="checkbox"/>	Mrs <input type="checkbox"/>	Miss <input type="checkbox"/>	Ms <input type="checkbox"/>	Other Title (for example, Rev)
Surname		First names		

□□□□

K

Please highlight any adult entertainment or services, activities, other entertainment or matters ancillary to the use of the premises that may give rise to concern in respect of children (please read guidance note 9).

NONE

L

Hours premises are open to the public Standard days and timings (please read guidance note 7)			State any seasonal variations (please read guidance note 5)
Day	Start	Finish	
Mon	08:00	00:00	
Tue	08:00	00:00	
Wed	08:00	00:00	
Thur	08:00	00:00	
Fri	08:00	00:00	
Sat	08:00	00:00	
Sun	08:00	00:00	

**Non standard timings. Where you intend the premises to be open to the public at different times from those listed in the column on the left, please list (please read guidance note 6)**

**M** Describe the steps you intend to take to promote the four licensing objectives:

**a) General – all four licensing objectives (b, c, d and e) (please read guidance note 10)**

See Attached Appendix.

**b) The prevention of crime and disorder**

See Attached Appendix

**c) Public safety**

See Attached Appendix

**d) The prevention of public nuisance**

See Attached Appendix.

**e) The protection of children from harm**

PO



See Attached Appendix

**Checklist:**

**Please tick to indicate agreement**

- I have made or enclosed payment of the fee.
- I have enclosed the plan of the premises.
- I have sent copies of this application and the plan to responsible authorities and others where applicable.
- I have enclosed the consent form completed by the individual I wish to be designated premises supervisor, if applicable.
- I understand that I must now advertise my application.
- I understand that if I do not comply with the above requirements my application will be rejected.
- [Applicable to all individual applicants, including those in a partnership which is not a limited liability partnership, but not companies or limited liability partnerships] I have included documents demonstrating my entitlement to work in the United Kingdom (please read note 15).

**IT IS AN OFFENCE, UNDER SECTION 158 OF THE LICENSING ACT 2003, TO MAKE A FALSE STATEMENT IN OR IN CONNECTION WITH THIS APPLICATION. THOSE WHO MAKE A FALSE STATEMENT MAY BE LIABLE ON SUMMARY CONVICTION TO A FINE OF ANY AMOUNT.**

**IT IS AN OFFENCE UNDER SECTION 24B OF THE IMMIGRATION ACT 1971 FOR A PERSON TO WORK WHEN THEY KNOW, OR HAVE REASONABLE CAUSE TO BELIEVE, THAT THEY ARE DISQUALIFIED FROM DOING SO BY REASON OF THEIR IMMIGRATION STATUS. THOSE WHO EMPLOY AN ADULT WITHOUT LEAVE OR WHO IS SUBJECT TO CONDITIONS AS TO EMPLOYMENT WILL BE LIABLE TO A CIVIL PENALTY UNDER SECTION 15 OF THE IMMIGRATION, ASYLUM AND NATIONALITY ACT 2006 AND PURSUANT TO SECTION 21 OF THE SAME ACT, WILL BE COMMITTING AN OFFENCE WHERE THEY DO SO IN THE KNOWLEDGE, OR WITH REASONABLE CAUSE TO BELIEVE, THAT THE EMPLOYEE IS DISQUALIFIED.**



**Part 4 – Signatures** (please read guidance note 11)

**Signature of applicant or applicant's solicitor or other duly authorised agent** (see guidance note 12). If signing on behalf of the applicant, please state in what capacity.

<b>Declaration</b>	<ul style="list-style-type: none"> <li>[Applicable to individual applicants only, including those in a partnership which is not a limited liability partnership] I understand I am not entitled to be issued with a licence if I do not have the entitlement to live and work in the UK (or if I am subject to a condition preventing me from doing work relating to the carrying on of a licensable activity) and that my licence will become invalid if I cease to be entitled to live and work in the UK (please read guidance note 15).</li> <li>The DPS named in this application form is entitled to work in the UK (and is not subject to conditions preventing him or her from doing work relating to a licensable activity) and I have seen a copy of his or her proof of entitlement to work, if appropriate (please see note 15)</li> </ul>
Signature	
Date	14.09.2017
Capacity	OWNER

For joint applications, signature of 2<sup>nd</sup> applicant or 2<sup>nd</sup> applicant's solicitor or other authorised agent (please read guidance note 13). If signing on behalf of the applicant, please state in what capacity.

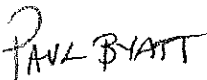
Signature	
Date	
Capacity	

Contact name (where not previously given) and postal address for correspondence associated with this application (please read guidance note 14)	
	
LICENSED-INN-TUITION 58 BROW OF THE HILL LEZIATE KING'S LYNN NORFOLK	
Post town	PE32 1EN Postcode
Telephone number (if any)	07704 656469      01853 630993
If you would prefer us to correspond with you by e-mail, your e-mail address (optional) licensedinn-tuition@btmail.com	

**Notes for Guidance**

- Describe the premises, for example the type of premises, its general situation and layout and any other information which could be relevant to the licensing objectives. Where your application includes off-supplies of alcohol and you intend to provide a place for consumption of these off-supplies, you must include a description of where the place will be and its proximity to the premises.
- In terms of specific regulated entertainments please note that:



and any premises licence to be granted or varied in respect of this application made by

SARBAZ AMIN ABDULLAH  
[name of applicant]

concerning the supply of alcohol at

' ARYAN COFFEE '  
166-168 LUTTERWORTH ROAD  
NORTHAMPTON  
NN1 5JL

[name and address of premises to which application relates]

I also confirm that I am entitled to work in the United Kingdom and am applying for, intend to apply for or currently hold a personal licence, details of which I set out below.

Personal licence number

W/NPA 009915.  
[insert personal licence number, if any]

Personal licence issuing authority

PORTFOLIO COUNCIL OF KINGS LYNN & WEST NORFOLK  
[insert name and address and telephone number of personal licence issuing authority, if any]

Signed

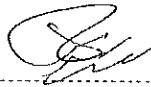

Name (please print)

SARBAZ AMIN ABDULLAH

Date

14. 09. 2017

**LICENSING ACT 2003**

*Copy of Premises Notice 'Aryan'*

**NOTICE OF APPLICATION FOR A PREMISES LICENCE**

Notice is given that Mr Sarbaz Abdullah has on the 10 October 2017, applied to Northampton Borough Council as the Licensing Authority for the grant of a Premises Licence in respect of;

'Aryan Coffee', 166-168 Lutterworth Road, Northampton, NN1 5JL.

To permit:

Sale of alcohol ( <i>for consumption on the premises</i> )	Mon – Sun	0800– 00.00 (midnight)
Late Night Refreshment	Mon – Sun	23.00– 00.00 (midnight)

Anyone wishing to make representations concerning this application should do so in writing to: Licensing Officer, Northampton Borough Council, The Guildhall, St Giles Square, Northampton, NN1 1DE

Representations in respect of this application must reach the Licensing Authority by 06 November 2017.

Persons wishing to inspect the register or the record of this application may do so by attending the office of the Licensing Section, during office hours, Monday to Friday inclusive.

It is an offence knowingly or recklessly to make a false statement in connection with an application, the maximum fine for which on summary conviction is £5,000.

Copy of Newspaper notice.

**LICENSING ACT 2003**

**NOTICE OF APPLICATION FOR A PREMISES LICENCE**

Notice is given that Sarbaz Abullah has on the 10 October 2017, applied to Northampton Borough Council as the Licensing Authority for the grant of a Premises Licence in respect of; 'Aryan Coffee', 166-168 Lutterworth Road, Northampton, NN1 5JL

To permit: **Sale of alcohol (for consumption on the premises)** Mon – Sun 0800 – 00.00.  
**Late Night Refreshment** Mon – Sun 2300 – 00.00

Anyone wishing to make representations concerning this application should do so in writing to: Licensing Officer, Northampton Borough Council, The Guildhall, St Giles Square, Northampton, NN1 1DE. Representations in respect of this application must reach the Licensing Authority by 06 November 2017. Persons wishing to inspect the register or the record of this application may do so by attending the office of the Licensing Section, by appointment, during office hours, Monday to Friday inclusive. It is an offence knowingly or recklessly to make a false statement in connection with an application, the maximum fine for which on summary conviction is £5,000.

**c) Public Safety**

- The premises will conform to all statutory health and safety Requirements

**d) The prevention of public nuisance**

- Persons shall be discouraged from congregating outside of the premises.
- The licence holder shall operate and maintain a refusals register in respect of declined sales of alcohol where the attempted purchaser was suspected of being under 18 years of age or drunk.

**e) The protection of Children from harm**

- The challenged 25 scheme will be implemented
- To ensure that any person selling or supplying alcoholic drink under the authority of a personal licence holder follows the guidelines of the Challenge 25 scheme and asks for photo ID proof of age where they have reason to suspect that the individual may be under 25 years of age and to ensure that signs relevant to this condition are prominently displayed at the premises.

---

Sunday	08:00	-	00:00
Monday	08:00	-	00:00
Tuesday	08:00	-	00:00
Wednesday	08:00	-	00:00
Thursday	08:00	-	00:00
Friday	08:00	-	00:00
Saturday	08:00	-	00:00
Non Standard Timings / Seasonal Variations			

'Aryan Coffee', 166 -168 Lutterworth Road, Northampton, NN1 5JL

**Premises PROPOSED Conditions:**

**Part M**

**Describe the steps you intend to take to promote the four licensing objectives**

**a) General – All Four Licensing objectives, (b,c,d and e)**

- The licence holder shall operate and maintain a refusals register in respect of declined sales of alcohol where the attempted purchaser was suspected of being under 18 years of age or drunk.
- Alcohol will only be supplied as ancillary to a meal. (Customers to be seated having ordered a 'substantial' meal.)
- The refusals register shall be kept on the premises and be made available immediately upon request to an authorised officer of the Police or Local Authority.
- The licence holder will ensure that within six weeks of any appointment of a member of staff, they receive adequate training in responsible alcohol retailing. A training record will be kept at the premises.

**b) The prevention of crime and disorder**

- CCTV WILL be provided in the form of a recordable system, capable of providing pictures of EVIDENTIAL QUALITY in all lighting conditions particularly facial recognition. Cameras shall encompass all ingress and egress to the premises and all areas where the sale/ supply of alcohol occurs. Equipment MUST be maintained in good working order, be correctly time and date stamped, recordings MUST be kept in date order, numbered sequentially and kept for a period of 28 days and handed to Police on demand.

The Premises Licence Holder must ensure that at all times the DPS and all appointed members of staff are capable and competent at downloading CCTV footage in a recordable format EITHER DISC or VHS to the Police/Local Authority on demand.

The Recording equipment and tapes/discs shall be kept in a secure environment under the control of the DPS or other responsible named individual.

An operational daily log report must be maintained endorsed by signature, indicating the system has been checked and is compliant, in the event of any failings actions taken are to be recorded.

In the event of technical failure of the CCTV equipment the Premises Licence holder/DPS MUST report the failure to the Police.

- The challenged 25 scheme will be implemented
- To ensure that any person selling or supplying alcoholic drink under the authority of a personal licence holder follows the guidelines of the Challenge 25 scheme and asks for photo ID proof of age where they have reason to suspect that the individual may be under 25 years of age and to ensure that signs relevant to this condition are prominently displayed at the premises.



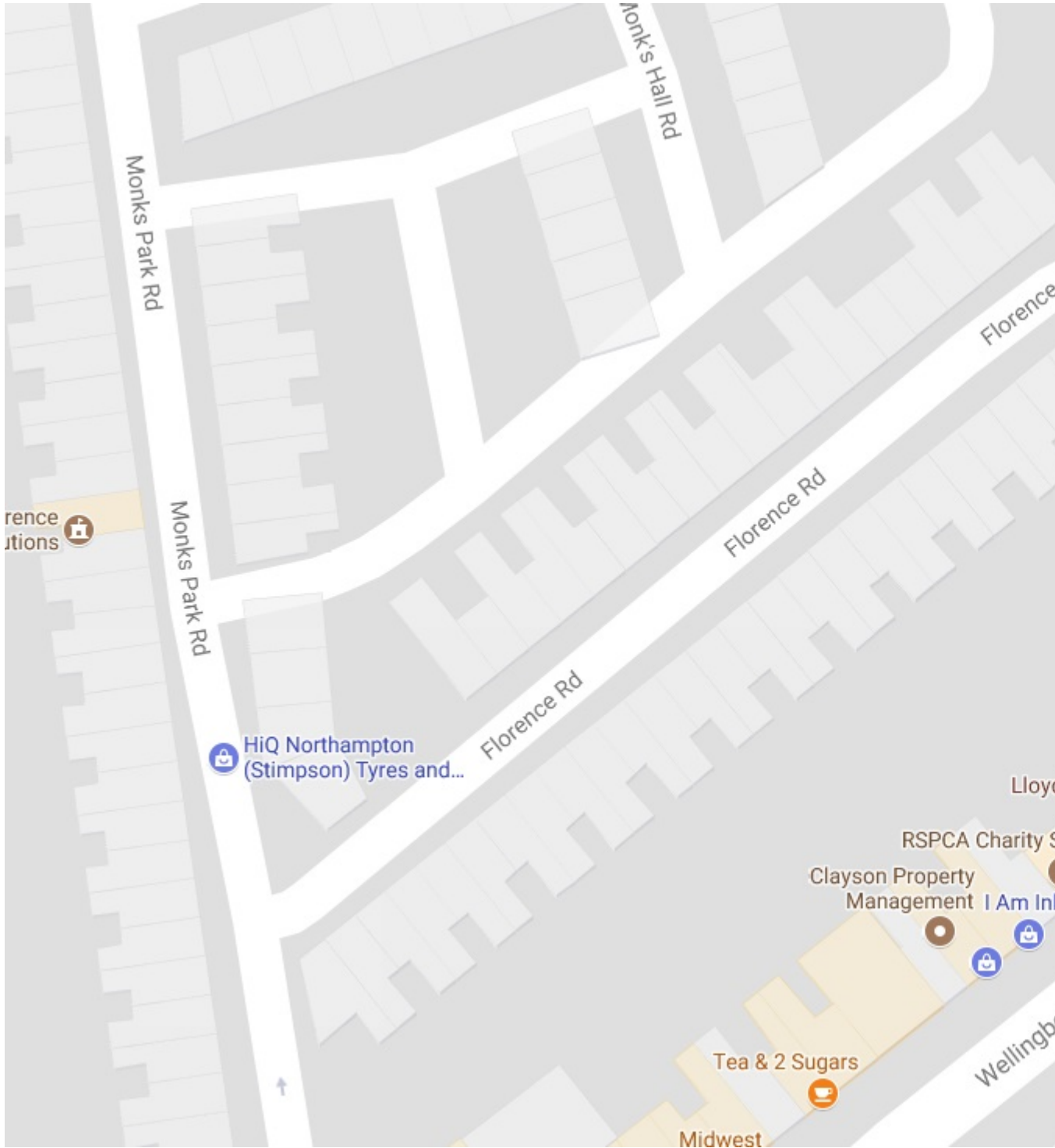

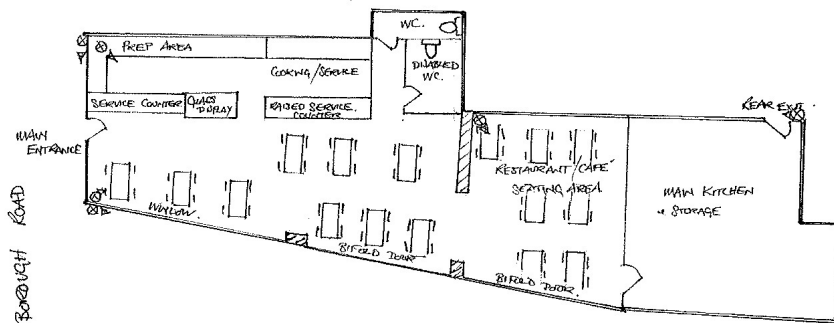

WELLINGBOROUGH ROAD

LUTTERWORTH ROAD

ARIAN COFFEE  
 166 - 168 LUTTERWORTH RD.  
 NORTHAMPTON  
 NN1 5JL

SCALE 1:100

© - CITY COUNCIL

**LICENSING ACT 2003**

**NOTICE OF APPLICATION FOR A PREMISES LICENCE**

Notice is given that Mr Sarbaz Abdullah has on the 10 October 2017, applied to Northampton Borough Council as the Licensing Authority for the grant of a Premises Licence in respect of;

'Aryan Coffee', 166-168 Lutterworth Road, Northampton, NN1 5JL.

To permit:

Sale of alcohol ( <i>for consumption on the premises</i> )	Mon – Sun	0800– 00.00 (midnight)
Late Night Refreshment	Mon – Sun	23.00– 00.00 (midnight)

Anyone wishing to make representations concerning this application should do so in writing to: Licensing Officer, Northampton Borough Council, The Guildhall, St Giles Square, Northampton, NN1 1DE

Representations in respect of this application must reach the Licensing Authority by 06 November 2017.

Persons wishing to inspect the register or the record of this application may do so by attending the office of the Licensing Section, during office hours, Monday to Friday inclusive.

It is an offence knowingly or recklessly to make a false statement in connection with an application, the maximum fine for which on summary conviction is £5,000.

## Ed Bostock

---

**From:** Stevens Chris <Chris.Stevens@northants.pnn.police.uk>  
**Sent:** 20 October 2017 14:10  
**To:** Paul Byatt  
**Cc:** Ormond Joy; Licensing Enforcement  
**Subject:** RE: The Aryan Cafe Northampton

Hi Paul,

Thanks for coming back to confirm.

Chris

Police Constable 1432 Chris Stevens  
Northamptonshire Police Licensing Officer



Prevention and Community Protection  
The Guildhall  
St Giles Square  
Northampton  
NN1 1DE

 Telephone 101 extension 345730

 Mobex: 778816 / 07557778816

 [chris.stevens@northants.pnn.police.uk](mailto:chris.stevens@northants.pnn.police.uk)

---

**From:** Paul Byatt [mailto:licensedinntuition@hotmail.com]  
**Sent:** 20 October 2017 14:09  
**To:** Stevens Chris <Chris.Stevens@northants.pnn.police.uk>  
**Subject:** Re: The Aryan Cafe Northampton

Hi Chris

I have spoken to my client regarding your suggested conditions and can confirm that he has agreed for them to be included on the licence should it be granted.

If you require any further information please do not hesitate to contact me.

Regards

Paul Byatt

Paul Byatt B.Ed MIH - Licensed Inn Tuition - 56 Brow of the Hill - Leziate - King's Lynn - Norfolk - PE32 1EN -  
TEL: 01553 630993 - MOBILE: 07704 65 64 69 - Licensed Inn Tuition - Training & Development Solutions for  
the Licensed Industry

**From:** Stevens Chris <[Chris.Stevens@northants.pnn.police.uk](mailto:Chris.Stevens@northants.pnn.police.uk)>  
**Sent:** 18 October 2017 13:13  
**To:** [licensedinintuition@hotmail.com](mailto:licensedinintuition@hotmail.com)  
**Subject:** The Aryan Cafe Northampton

Good afternoon Paul,

I have received a copy of the above premises licence application. While I have no objection in principle to this licence being granted, I would appreciate the wording of some of the proposed conditions being altered slightly and as below:

- 1) A fully working and maintained CCTV system capable of recording and storing images must be installed on the premises. The system must record at all times the premises s open to the public and images must be stored for a minimum of 28 days with date & time stamping. As a minimum this must cover all entry and exit points, both sides of all areas where the sale/supply of alcohol takes place.
- 2) All recordings must be made available to an officer from a responsible authority upon reasonable request and in line with the provisions of the Data Protection Act 1998.
- 3) All staff involved in the retail of alcohol will be trained in relation to the law regarding its sale. This training must be completed prior to them being authorised to sell alcohol and refreshed every 12 months as a minimum. A record of this training must be kept and maintained with a copy of the syllabus attached. The recipient of the training must sign to state that they have received and understood the training and this should be dated. Training records must be kept on the premises at all times and made available to an officer from a responsible authority upon reasonable request.
- 4) Customers must not take open vessels of alcohol from the premises at any time unless there is an authorisation such as a street café licence in place. Where such an authorisation is in place open vessels of alcohol must not be taken beyond the boundaries indicated by the licence.
- 5) The premises will operate and adhere to an age verification scheme with the minimum standard of Challenge 25. Signs advertising the policy must be displayed in all areas where alcohol is for sale.

This will be a like for like swap of the relevant conditions you have already proposed just as a way of clarifying some of them.

If you are happy with the amended wording, I would be grateful if you could confirm this by way of a reply email.

Thanks

Chris

Police Constable 1432 Chris Stevens

Northamptonshire Police Licensing Officer



Prevention and Community Protection

The Guildhall

St Giles Square

Northampton

NN1 1DE

 **Telephone 101 extension 345730**

 **Mobex: 778816 / 07557778816**

 [chris.stevens@northants.pnn.police.uk](mailto:chris.stevens@northants.pnn.police.uk)

---

NORTHAMPTONSHIRE POLICE - Visit us at <http://www.northants.police.uk>

This message may contain privileged and confidential information. If you are not the intended recipient, unauthorised use or disclosure may be unlawful. If you have received this message in error, please notify the sender immediately. The information contained in this e-mail, and in your reply, may be subject to disclosure under the Freedom of Information Act 2000 or other legislation and confidentiality cannot be guaranteed. Opinions expressed in this email may not be official policy. Northamptonshire Police monitors Internet and email activity. Help the environment. Only print this email if absolutely necessary.

---

This email has been scanned by the Symantec Email Security.cloud service.

---

---

NORTHAMPTONSHIRE POLICE - Visit us at <http://www.northants.police.uk>

This message may contain privileged and confidential information. If you are not the intended recipient, unauthorised use or disclosure may be unlawful. If you have received this message in error, please notify the sender immediately. The information contained in this e-mail, and in your reply, may be subject to disclosure under the Freedom of Information Act 2000 or other legislation and confidentiality cannot be guaranteed. Opinions expressed in this email may not be official policy. Northamptonshire Police monitors Internet and email activity. Help the environment. Only print this email if absolutely necessary.

Proposed Northamptonshire Police Licensing Conditions, Aryan Coffee :-

- 1) A fully working and maintained CCTV system capable of recording and storing images must be installed on the premises. The system must record at all times the premises s open to the public and images must be stored for a minimum of 28 days with date & time stamping. As a minimum this must cover all entry and exit points, both sides of all areas where the sale/supply of alcohol takes place.
- 2) All recordings must be made available to an officer from a responsible authority upon reasonable request and in line with the provisions of the Data Protection Act 1998.
- 3) All staff involved in the retail of alcohol will be trained in relation to the law regarding its sale. This training must be completed prior to them being authorised to sell alcohol and refreshed every 12 months as a minimum. A record of this training must be kept and maintained with a copy of the syllabus attached. The recipient of the training must sign to state that they have received and understood the training and this should be dated. Training records must be kept on the premises at all times and made available to an officer from a responsible authority upon reasonable request.
- 4) Customers must not take open vessels of alcohol from the premises at any time unless there is an authorisation such as a street café licence in place. Where such an authorisation is in place open vessels of alcohol must not be taken beyond the boundaries indicated by the licence.
- 5) The premises will operate and adhere to an age verification scheme with the minimum standard of Challenge 25. Signs advertising the policy must be displayed in all areas where alcohol is for sale.

## Ed Bostock

---

**From:** Gavin Smith  
**Sent:** 20 October 2017 13:33  
**To:** Licensing  
**Cc:** Louise Faulkner  
**Subject:** Re: Premises Licencing Application - Aryan Coffee, 166-168 Lutterworth Road, NN1 5JL

Dear Team,

Environmental Protection have considered the above mentioned premises licence application pertinent to the licencing objective of the prevention of public nuisance.

The only noise related condition I would recommend is that only background music can be played during permitted opening hours.

Kind regards

**Gavin Smith**  
Senior Environmental Health Officer  
Customers & Communities (Regulatory Services)

**Northampton Borough Council**  
The Guildhall, 1<sup>st</sup> Floor, St Giles Street, Northampton, NN1 1DE  
Tel: (01604) 837648; Main Switchboard: 0300 330 7000; Fax: (01604) 838755





67460

LUTTERWORTH ROAD  
NORTHAMPTON  
NN1 5JL

Licensing Department  
Northampton Borough Council  
The Guildhall  
Northampton  
NN1 1DE

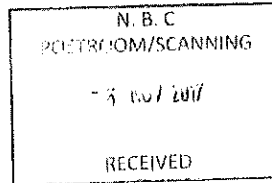

3<sup>rd</sup> November 2017

Dear Sirs

**Alcohol Licence Application – Arayn Coffee Wellingborough Road/Lutterworth Road**

We are writing to object to the terms of the Alcohol Licence application for the above premises and particularly with regard to the hours for which the application has been made.

The premises is a coffee shop open from 8.00 am until 6.00pm, but the application is to serve alcohol until at least midnight. This changes the nature of the premises totally.

Our objection is on two grounds:-

Firstly, on the grounds of public nuisance. The premises is on the corner of a residential street. There is already an issue with noise late at night at the weekends due to the close proximity of the various bars, pubs and restaurants on the Wellingborough Road.

This will be made worse by a licensed premises immediately adjacent to residential properties.

Further, there is no smoking area for the premises. Customers to a coffee shop are likely to stay no longer than an hour or so and are unlikely to feel the need for a cigarette. Customers eating and drinking alcohol are far more likely to stay for a longer period and are more likely to want to smoke. This will no doubt create an informal smoking area on the Wellingborough Road or more likely in Lutterworth Road and quite possibly around the entrance to the back of the shops and the flats at the top of Lutterworth Road. This will create noise and a nuisance.

Secondly, on the grounds of the cumulative impact of the large number of existing licences already granted. There are already 4 shops (Tesco Express, European Supermarket, Premier and Co-Op), 2 restaurants (Mensaab, Transylvannia, Imrans) and then Corkers all within close proximity, that is before you reach the pubs, ie. Pickering Phipps, Lighthouse, Crown and Cushion etc further down the Wellingborough Road.

The area is awash with a variety of premises selling alcohol in various forms, with and without meals and a further licence is unnecessary and excessive and will have an adverse effect on the area and the residents in it.

Please arrange to put these objections forward and we await hearing from you further.